

NOTICE!!

These documents have been scanned!

Do not place un-scanned documents beneath this notice!

Do not remove this notice from this file!

GPO Jacket No. 560-102
Print Order 61540
Rise Business Services, LLC
Job=AZ15 7/11/2019



Box Number= AZ15155



Claim Begin-End: AMC452336-AMC452336

1 Initial Receipt



AZ15155-36

AMC452349-AMC452348

United States Department of the Interior
Bureau of Land Management
 DIV OF LANDS, MINRLS & ENERGY
 ONE N CENTRAL AVE
 PHOENIX, AZ 85004 -4427
 Phone: 602-417-9200

Receipt

No: 4287301

| | | |
|--|---|--|
| Transaction #: 4403336 | |  |
| Date of Transaction: 10/19/2018 | | |
| CUSTOMER: | | |
| | RYAN REED 12251 N NEW DAWN AVE ORO VALLEY, AZ 85755-1607 US | |

| LINE # | QTY | DESCRIPTION | REMARKS | UNIT PRICE | TOTAL |
|---------------|------|---|---------|------------|-----------------|
| 1 | 1.00 | LOCATABLE MINERALS / MINING CLAIMS-NEW, UNADJUD, ONE OR MORE AUTH NOS / NEW MINING CLAIM PROCESSING FEE CASES: AMC452336/\$20.00 | | - n/a - | 20.00 |
| 2 | 1.00 | LOCATABLE MINERALS / MINING CLAIMS-NEW, UNADJUD, ONE OR MORE AUTH NOS / NEW MINING CLAIMS LOCATION FEE CASES: AMC452336/\$37.00 | | - n/a - | 37.00 |
| 3 | 1.00 | LOCATABLE MINERALS / MINING CLAIMS-NEW, UNADJUD, ONE OR MORE AUTH NOS / NEW MINING CLAIMS MAINTENANCE FEE CASES: AMC452336/\$155.00 | | - n/a - | 155.00 |
| TOTAL: | | | | | \$212.00 |

| PAYMENT INFORMATION | | | |
|---------------------|-----------|---|----------------------|
| 1 | AMOUNT: | 212.00 | POSTMARKED: N/A |
| | TYPE: | CHECK | RECEIVED: 10/19/2018 |
| | CHECK NO: | 3768 | |
| | NAME: | REED, RYAN 12251 N NEW DAWN AVE ORO VALLEY AZ 85755-1607 US | |

| |
|---------|
| REMARKS |
| |

This receipt was generated by the automated BLM Collections and Billing System and is a paper representation of a portion of the official electronic record contained therein.

NOTICE!!

These documents have been scanned!

Do not place un-scanned documents beneath this notice!

Do not remove this notice from this file!

GPO Jacket No. 560-102
Print Order 61540
Rise Business Services, LLC
Job=AZ15 7/11/2019



Box Number= AZ15155



Claim Begin-End: AMC452336-AMC452336

2 Correspondence

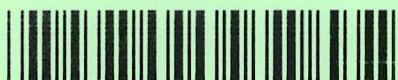

AZ15155-36

AMC452349-AMC452348

**NO
DOCUMENTS
FOUND**

NO DOCUMENTS FOUND
NO DOCUMENTS FOUND

NOTICE!!

These documents have been scanned!

Do not place un-scanned documents beneath this notice!

Do not remove this notice from this file!

GPO Jacket No. 560-102
Print Order 61540
Rise Business Services, LLC
Job=AZ15 7/11/2019



Box Number= AZ15155



Claim Begin-End: AMC452336-AMC452336

3 Transfers



AZ15155-36

AMC452349-AMC452348

**NO
DOCUMENTS
FOUND**

NO DOCUMENTS FOUND
NO DOCUMENTS FOUND

NOTICE!!

These documents have been scanned!

Do not place un-scanned documents beneath this notice!

Do not remove this notice from this file!

GPO Jacket No. 560-102
Print Order 61540
Rise Business Services, LLC
Job=AZ15 7/11/2019



Box Number= AZ15155



Claim Begin-End: AMC452336-AMC452336

4 Annual Filings



AZ15155-36

AMC452349-AMC452348

**NO
DOCUMENTS
FOUND**

NO DOCUMENTS FOUND
NO DOCUMENTS FOUND

NOTICE!!

These documents have been scanned!

Do not place un-scanned documents beneath this notice!

Do not remove this notice from this file!

GPO Jacket No. 560-102
Print Order 61540
Rise Business Services, LLC
Job=AZ15 7/11/2019



Box Number= AZ15155



Claim Begin-End: AMC452336-AMC452336

5 Miscellaneous



AZ15155-36

AMC452349-AMC452348

October 15, 2018
Bureau of Land Management
1 N Central Ave Suite 800
Phoenix, Az
85004

RE: Recording of lode mining claim

To Whom it May Concern,

Enclosed are the Location Notice and Mining Claim Map for the Lode Claim "Dareedos" for recording with the BLM. It is an exact copy of the Location Notice and Mining Claim Map recorded with Pima County on 12 October, 2018.

The claim has been fully monumented at the corners and on the end center lines. I have also included a check for \$212 for the filing fee.

Let me know if you need more information.

Sincerely,

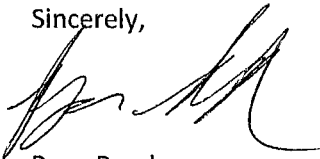

Ryan Reed
12251 N New Dawn Ave
Oro Valley, AZ
85755

(520) 481-2366

RECEIVED
BLM AZ STATE OFFICE
2018 OCT 18 P 2:49
PHOENIX, ARIZONA

ANCI452336

NOTICE!!

These documents have been scanned!

Do not place un-scanned documents beneath this notice!

Do not remove this notice from this file!

GPO Jacket No. 560-102
Print Order 61540
Rise Business Services, LLC
Job=AZ15 7/11/2019



Box Number= AZ15155



Claim Begin-End: AMC452336-AMC452336

6 Location Notices-Amendments and Supporting Documents



AZ15155-36

AMC452349-AMC452348

MINING CLAIM STATUS REPORT

Data Entered: 10/23/2018

MTP Checked By: EG
GEO Checked By: EG

LEAD SERIAL NUMBER: AMC 452336 thru AMC 452336

NUMBER OF CLAIMS & TYPE:

1 LODE
____ PLACER
____ ASSOCIATION PLACER
____ MILL SITE
____ TUNNEL SITE

CHARGES:

Processing Fee @ \$20 = \$ 20
Location Fee @ \$37 = \$ 37
Maintenance Fee @ \$155 = \$ 155
Add'l Maint Fee for Assoc Placer = \$ _____
SUBTOTAL \$ 212
Other Fees \$ _____
Other Fees \$ _____
TOTAL \$ _____

TOTAL ACREAGE: _____ Per Claim
(Placer Only)

NUMBER OF LOCATORS: 2

DOCUMENTS RECEIVED VIA: Over-the-Counter [] Mail TIMELY FILED: Yes No []

LEGAL DESCRIPTION: T 19S R 15E SEC 25
T _____ R _____ SEC _____
T _____ R _____ SEC _____
T _____ R _____ SEC _____
T _____ R _____ SEC _____

BLM [] FOREST SERVICE CORONADO SUBJ TO PL 359: Yes [] No []
WILDERNESS AREA [] _____

SPLIT ESTATE: N/A [] SX [] PX [] OTHER [] _____
SRHA [] Was proper Notice filed if located on SHRA Land? Yes [] No []

RECONVEYED MINERALS ON BLM LAND REQUIRE OPENING ORDER FROM 1944 TO 1993:

Open to Entry On _____ N/A []

COMMENTS/STATUS: VOID [] PARTIALLY VOID [] PVT MINERALS [] WITHDRAWN LANDS []
OTHER [] _____

[] Claimant acknowledges that portions of the following claim(s) site(s) may be void or voidable.

Printed Name of Claimant _____ Signature of Claimant _____

*****FINAL ADJUDICATION*****

DATE _____ INITIALS _____

AMC452336

RECEIVED
BLM AZ STATE OFFICE
2018 OCT 18 P 2:40
PHOENIX, ARIZONA

LOCATION NOTICE FOR LODE MINING CLAIM

Amendment BLM Serial # _____

NOTICE IS HEREBY GIVEN that the Dareedos
_____ lode mining claim has been located

by Ryan Reed, Connor Reed whose current mailing
address is 12251 N New Dawn Ave
Oro Valley, Az, 85755

BLM
Date
Stamp

The general course of this claim is East and it is situated in Pima
County, Arizona. This claim is 1500 feet in length and 600 feet in width.

20.66 Total Claim Acreage. This claim runs from the location monument on which this location notice
is posted on the centerline of the claim approximately 750 feet in a East direction to the East
end line and 750 feet in a West direction to the West end line. This claim is marked by six
monuments, one at each corner and one at the center of each end line of the claim.

The location monument on which this notice is posted is situated within Section 25, Township 19
S, Range 15 E, Gila Salt River Base and Meridian, Arizona and this claim encompasses portions
of the following quarter section(s), section(s), Township(s) and Range(s) The NW 1/4 Section
of Section 25 T19S R15E

Gila Salt River Base and Meridian, Arizona.

The locality of this claim with reference to some natural object or permanent monument and additional information
(if any) concerning its locality are as follows: The center of the claim is
approximately 700 ft SSW of the Peak of Granite
Mountain

The above information is shown on the attached map.

DATED AND POSTED on the ground this 12 day of October, 2018.

LOCATOR(s) AGENT

Print Name(s) RYAN REED, Connor Reed

Signature(s) [Handwritten Signatures]

Form MCF100
Revised July 2014

AN0452336

MINING CLAIM MAP

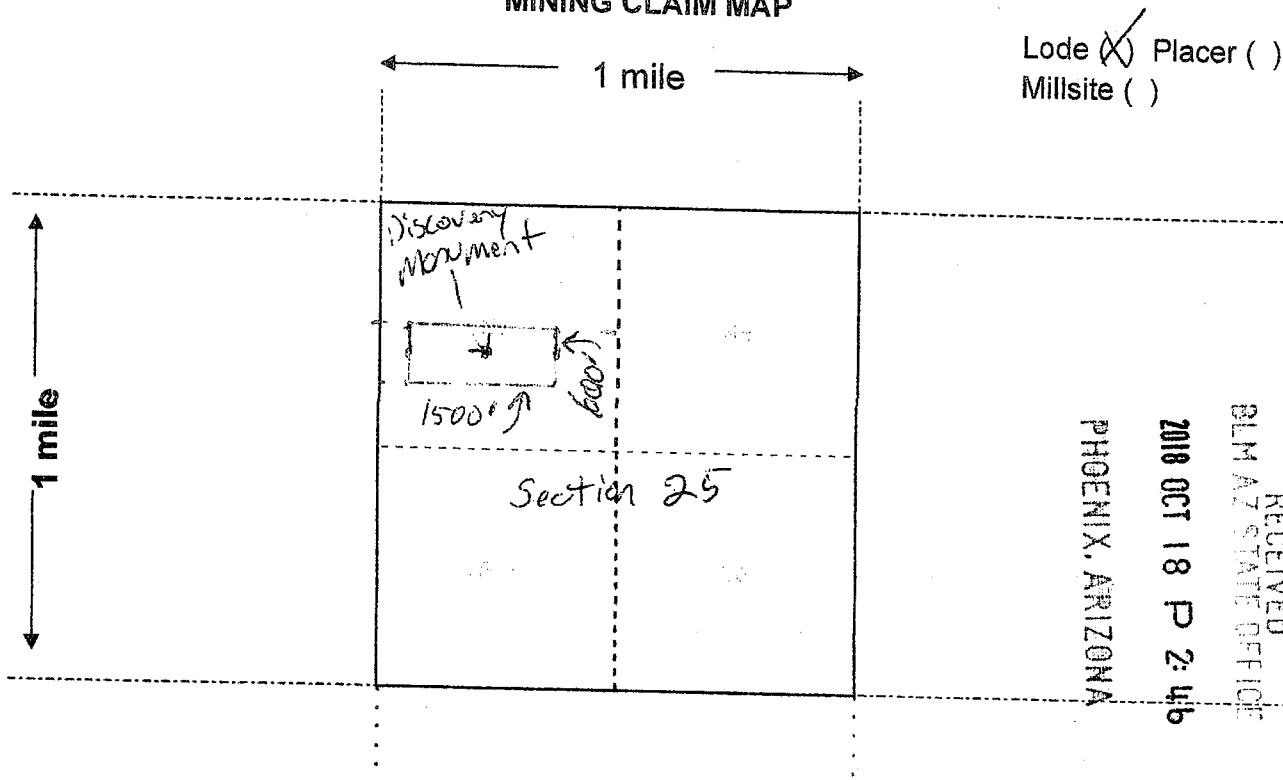

Lode (X) Placer ()
Millsite ()

RECEIVED
BLM AZ STATE OFFICE
2018 OCT 18 P 2:46
PHOENIX, ARIZONA

Scale: 1" = 2000 feet



1. The above map depicts the Dareedos mining claim, which is located in Section (s) 25, Township 19 S, Range 15 E, Gila and Salt River Base and Meridian, Pima County, Arizona. Total claim acreage is 20.66
2. The type of corner and location monuments used are as follows: 12" capped PVC on metal posts for location and corners
3. The bearings and distances in degrees and feet between claim corners and to a public land survey monument are as depicted on the map.
4. If the claim is a placer or millsite claim with exterior limits conforming to legal subdivisions of the public survey, provide a legal description of the claim N/A

AN0452336

Form MCF100a
Revised July 2014

This form is available from the Arizona Geology Survey and may be reproduced.

DEPARTMENT OF THE INTERIOR
BUREAU OF LAND MANAGEMENT
Case Recordation

Geographic Report with Land

Disposition is equal to **AUTHORIZED , CANCELLED , EXPIRED , PENDING , REJECTED , RELINQUISHED ,
WITHDRAWN**

and Meridian Township Range Section is equal to **14 0190S 0150E 025**

and Admin State is equal to **AZ**

DEPARTMENT OF THE INTERIOR
BUREAU OF LAND MANAGEMENT
Case Recordation
Geographic Report with Land

Admin State: AZ
Geo State: AZ

| Serial Number | Total Case Acres: | Casetype | Case Disp | Mer | Twp | Rng | Sec | Sur Type | Sur Nr | Suf | Subdivision | Act Pend |
|---------------|-------------------|----------|------------|-----|-------|-------|-----|----------|--------|-----|-------------|----------|
| AZA 02355701 | 3,057.955 | 218009 | AUTHORIZED | 14 | 0190S | 0150E | 025 | MS | 1791 | 1 | | |
| AZA 023557PT | 3,057.955 | 220200 | AUTHORIZED | | | | | MS | 1791 | 1 | | |
| AZA 035149 | 1.000 | 835002 | AUTHORIZED | | | | | FF | | | M&B; | |

R. Reed
12251 N New Dawn Ave
Oro Valley, AZ
85755

Bureau of Land Management
1 N Central Ave, Suite 800
Phoenix, AZ
85004

PHOENIX AZ 852

16 OCT 2018 PM 3 L



RECEIVED
BLM AZ STATE OFFICE
2018 OCT 18 P 2:45
PHOENIX, ARIZONA

85004-442700

